

AT A GLANCE

St Edmund Hall



University of Oxford
St Edmund
Hall



University of Oxford
St Edmund
Hall

www.seh.ox.ac.uk

Front Quad

- 1 Porters' Lodge (staff pigeon holes)
- 2 Student pigeon holes
- 3 Chaplain & Counsellor (second floor)
- 4 Admissions Office
- 5 Director of Music
- 6 Emden Rooms 1 & 2 (first floor)
- 7 Domestic Bursar
- 8 Bursary & Accommodation
- 9 College Office
- 10 Chapel & Vestry
- 11 MCR Study
- 12 Middle Common Room (MCR)
- 13 Well Bar
- 14 Welfare Room (first floor)
- 15 Buttery Bar
- 16 Hearne Room (first floor)
- 17 Old Dining Hall
- 18 Library

Rear Quad

- 19 Old Library (first floor)
- 20 Senior Common Room (SCR, first floor)
- 21 Mingos Suite (first floor)
- 22 Wolfson Hall
- 23 Pontigny Room
- 24 Junior Common Room (JCR)
- 25 Upper Quad
- 26 HR Office (Emden UG1)
- 27 Chough Room Foyer (first floor)
- 28 Jarvis Doctorow Hall (first floor)

Quick Guide to
St Edmund Hall

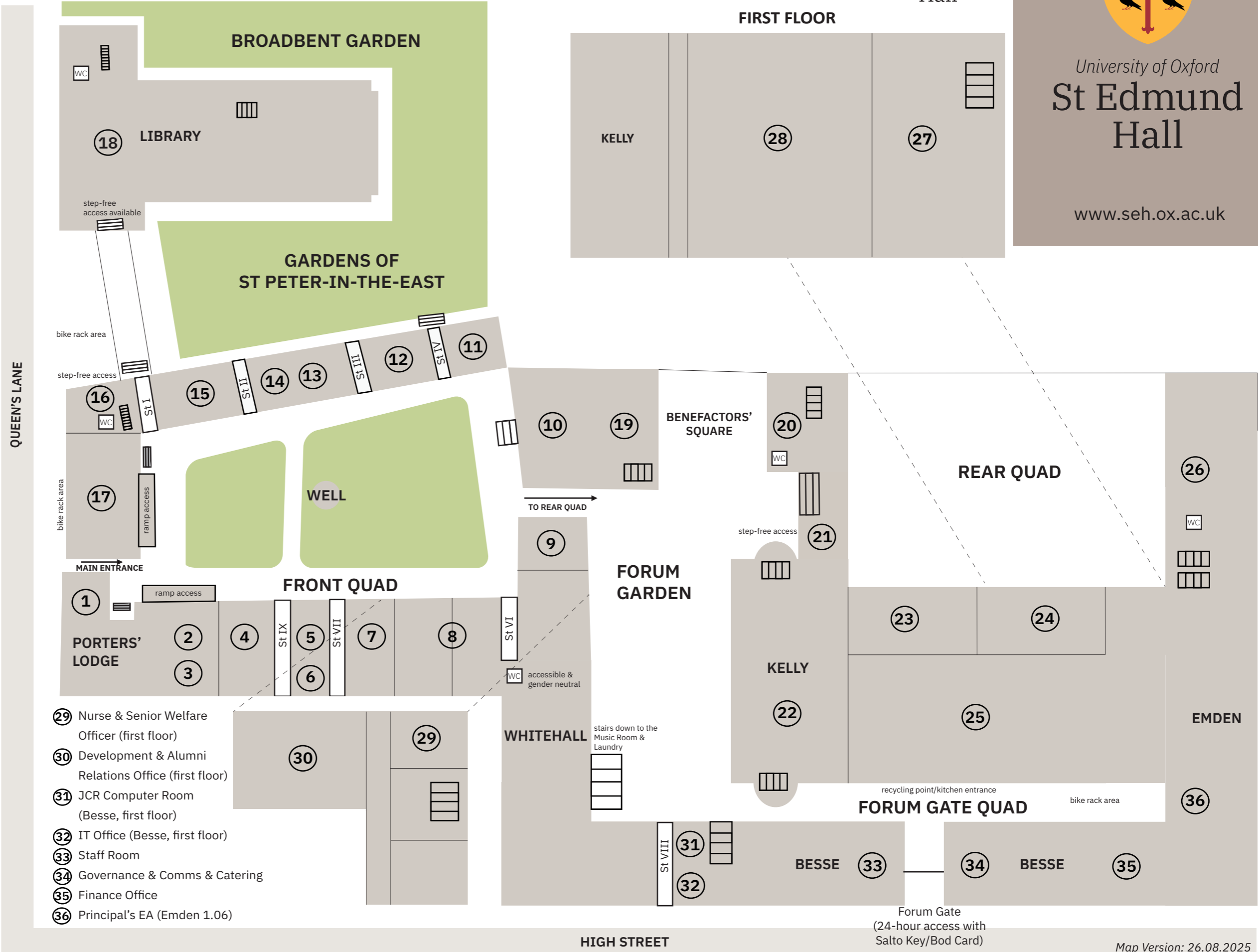

Finance

For information about battels, fees and charges,
or to request payment from College.
01865 279042
fees@seh.ox.ac.uk
End of Forum Gate Quad (ground floor)

Bursary

For accommodation, meals, events (including
conferences) and room bookings.
01865 279007
bursary@seh.ox.ac.uk
Staircase VI (ground floor)

Maintenance

For maintenance issues.
help@seh.ox.ac.uk

College Office

For all academic business, from registration to
graduation.
01865 279088
college.office@seh.ox.ac.uk
Staircase V, the archway between the Front and
Rear Quads (ground floor)

Development & Alumni
Relations Office

01865 279087
alumni@seh.ox.ac.uk
Staircase VI, opposite Nurse (first floor)

Health & Welfare

College Nurse: 01865 279063
Senior Welfare Officer: 01865 289132
welfare@seh.ox.ac.uk
Staircase VI (first floor)

IT Office

01865 279044
help@seh.ox.ac.uk
Besse (first floor)

EA to the Principal

For contact with the Principal.
01865 279003
principals.ea@seh.ox.ac.uk
Emden 1.06 (Upper Quad)

Communications Office

For website, branding and press enquiries.
01865 279366
communications@seh.ox.ac.uk
Forum Gate Quad (ground floor)

Porters’ Lodge – General Enquiries

01865 279000 (main switchboard)
lodge@seh.ox.ac.uk

Note: If you wish to make a call from an internal
phone, simply use the last five digits of the
number.





Outside Properties (Wardens)

Tamesis & William R. Miller: 01865 613700
Norham Gardens: 01865 279080



Map Version: 26.08.2025

Connect with us online

-  St Edmund Hall, University of Oxford
-  @stedmundhall
-  St Edmund Hall
-  @stedmundhall

Outside Properties

- Tamesis House, 45–53 Iffley Road, OX4 1ED
- William R. Miller Building, 22 Dawson Street, OX4 1GF
- 19 Norham Gardens, OX2 6PS
- 24 & 26 Norham Gardens, OX2 6PS
- 1 Crick Road, OX2 6QJ
- 7, 8, 10 & 10a Circus Street, OX4 1JR
- 8–10 Essex Street, OX4 3AW

Offices are usually open on weekdays.
Please note that opening times are
subject to change.

